

KARBANK

REAL ESTATE COMPANY

119th Street Tech Park - Building 5 16900 W. 118th Terrace Olathe, KS



13,727 SF - FOR LEASE Headquarters/Office/Hi-Tech Building

- Abundant Parking
- Excellent signage opportunities
- Great access to I-35 & 119th Street Corridor
- \$13.25 Net

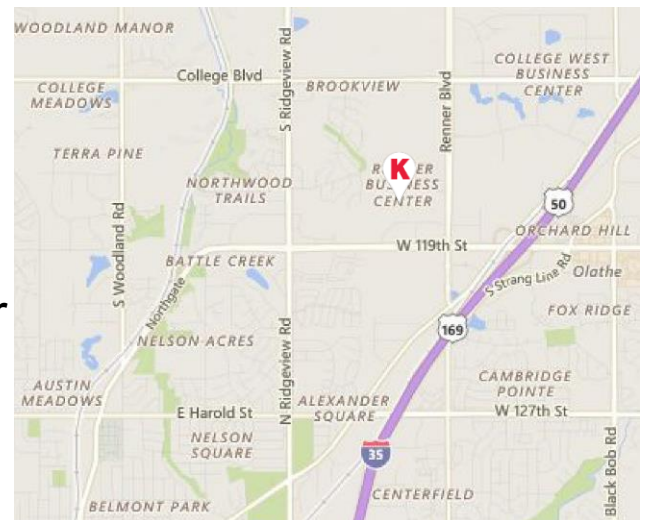

JACK ALLEN, SIOR ja@karbank.com

STEVE KARBANK sk@karbank.com

JOHN DELZER jd@karbank.com

THE BARNEY BUILDING
2000 SHAWNEE MISSION PARKWAY
SUITE 400
MISSION WOODS, KANSAS 66205

INDUSTRIAL | OFFICE | COMMERCIAL
BROKERAGE & DEVELOPMENT
ESTABLISHED 1950

816.221.4488 MAIN
816.221.4494 FAX
KARBANK.COM

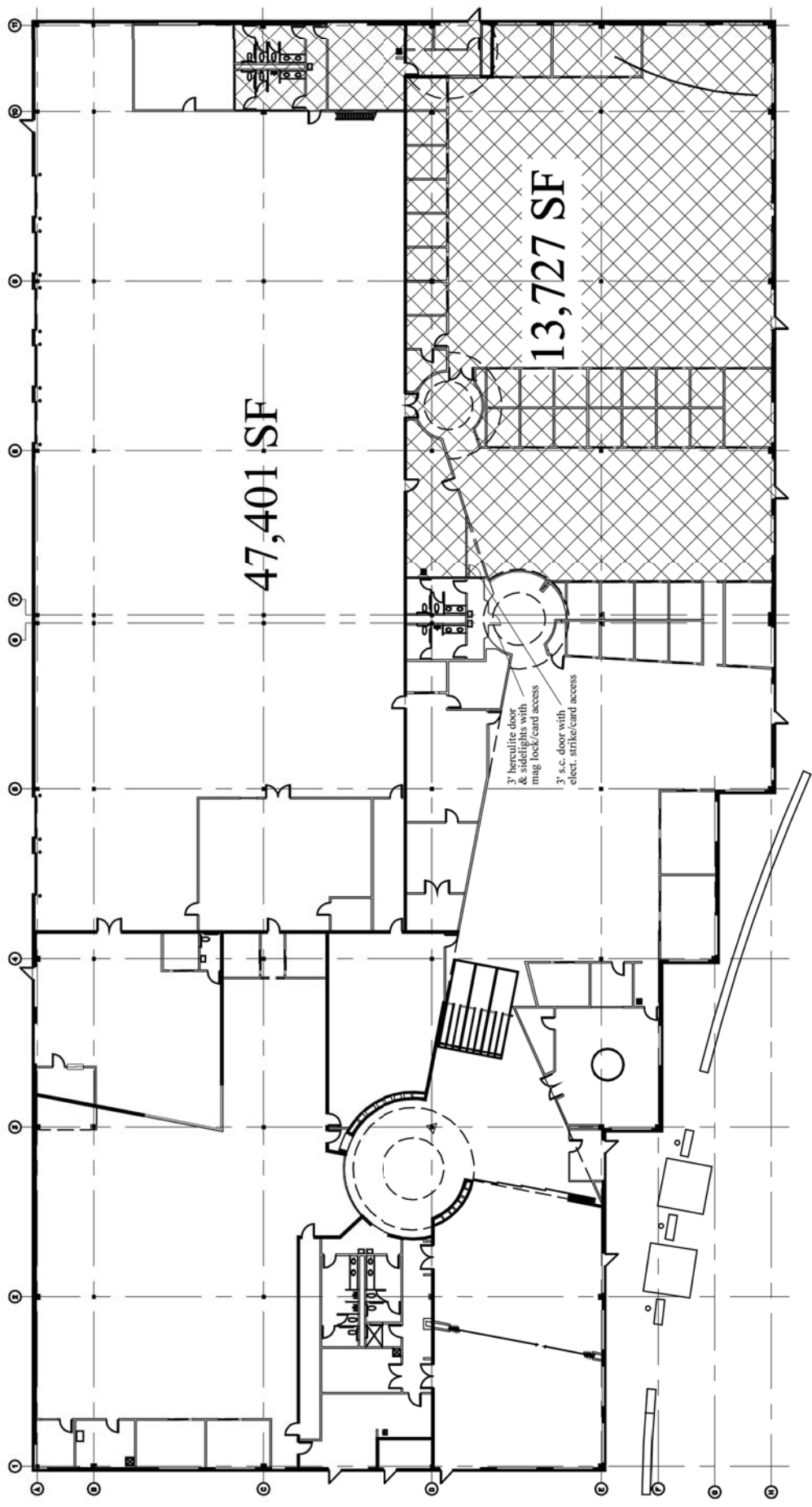

KARBANK REAL ESTATE COMPANY <small>THE BARNEY BUILDING 2000 SHAWNEE MISSION PARKWAY SUITE 400 MISSION WOODS, KANSAS 66205 KARBANK.COM</small>	ADDRESS 16900 W. 118th Terrace Olathe, KS		
	PLAN TYPE BTS	TOTAL SF 13,727	
		TOTAL OFFICE SF BTS	SCALE N/A



ARCHITECTURE

REES
MANTLONIS
TURLEY
1008 BRIDGEMAN 6TH FLOOR
KANSAS CITY MO 64105
816 842 1202
816 842 1078
ARCHITECTUREMT.COM

A PROJECT OF
KARBANK
REAL ESTATE COMPANY

1200 MAIN STREET : SUITE 3910
KANSAS CITY, MO. 64105
T 816.221.4488 : F 816.221.4494
KARBANK.COM

119th Street Technology Park

119th Street and Renner Road - NW Corner
Olathe, KS. 66061

AUGUST 4, 2008

SHEET NUMBER

A01